

COLUMN COVER REMOVAL/INSTALLATION

id091700800800

1. Pull down the steering wheel.
2. Press the shaded area shown in the figure, lift the upper column cover in the direction of the arrow, and detach the pins, tabs, and guides of the upper column cover from the lower column cover.

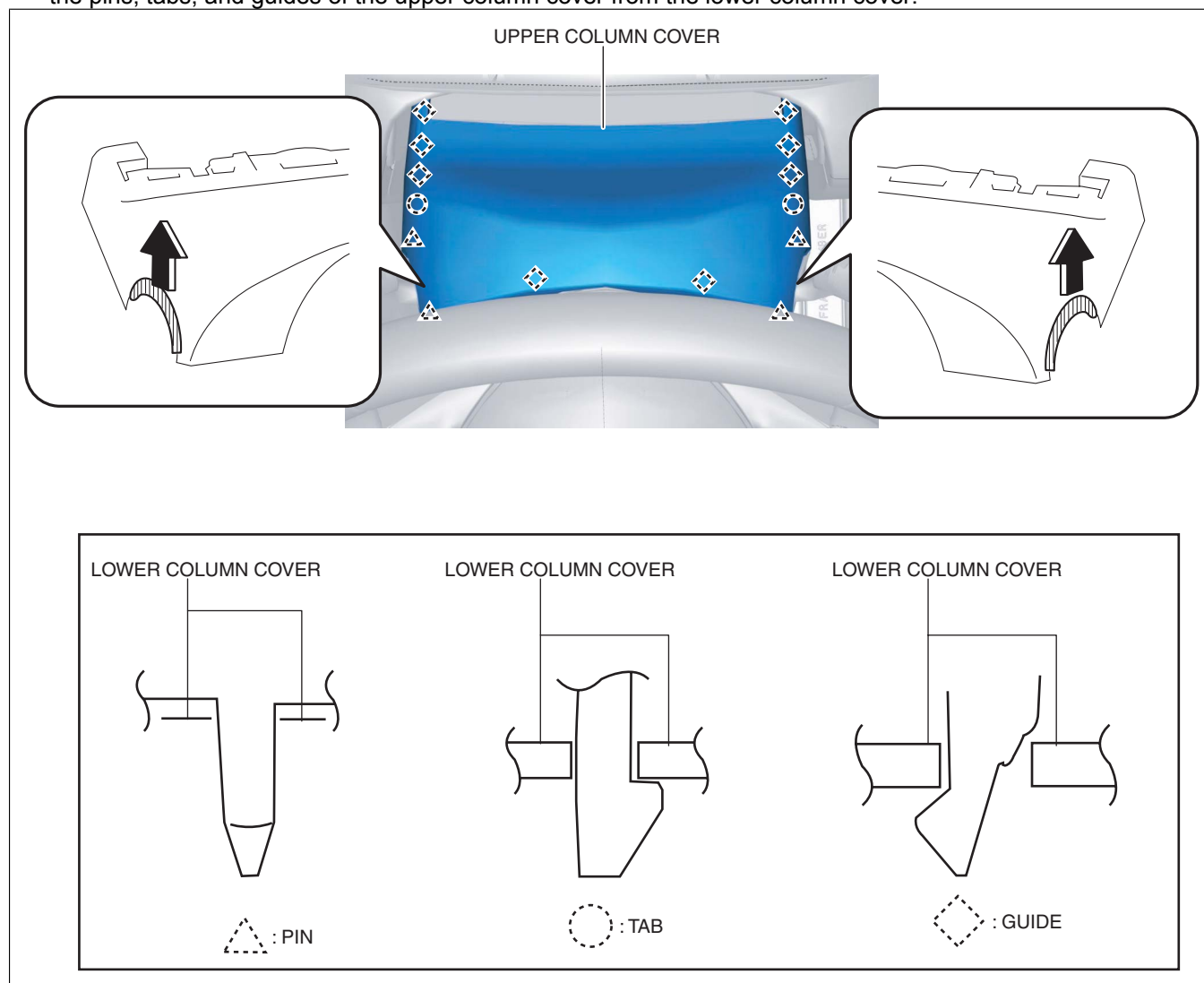

am6xuw00007499

3. Remove hooks from the meter hood.

Caution

- If the cover of the meter hood is deformed, it may not return to its original condition. When removing the cover of the meter hood, detach hooks one by one from the upper column cover.

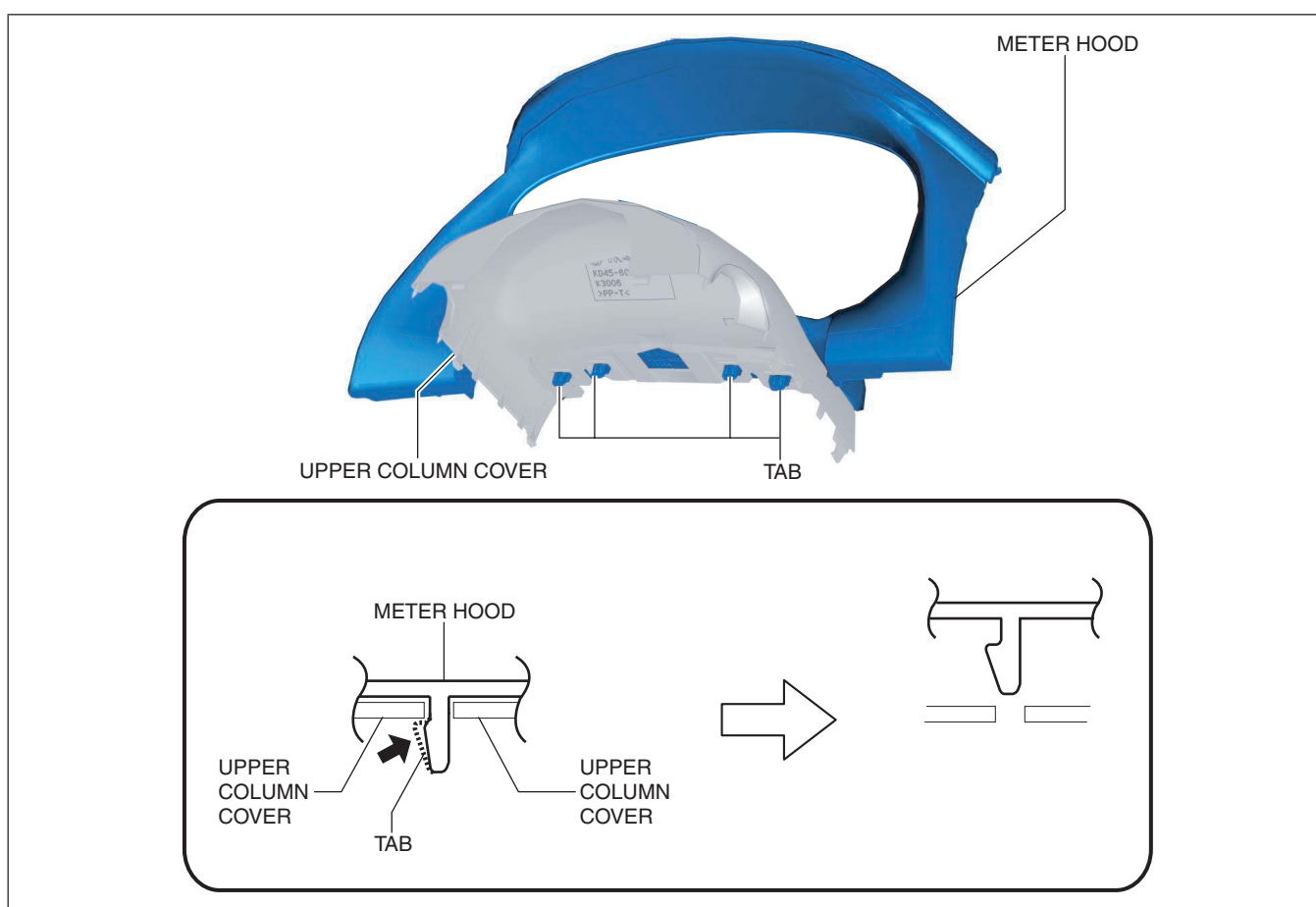

am6zzw00013454

4. Pull up the steering wheel.
5. Remove screws.

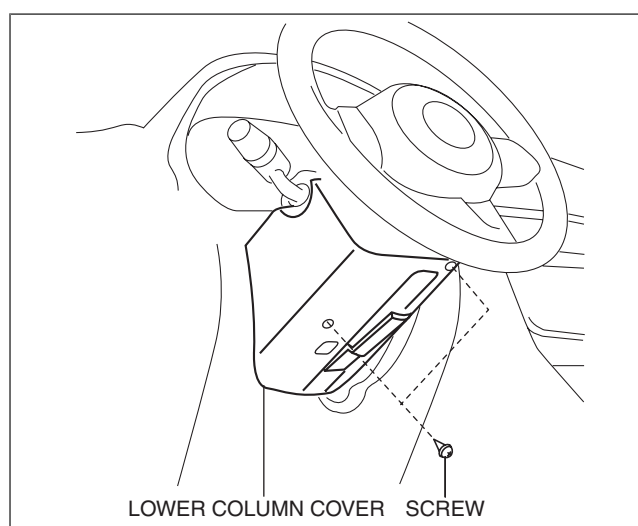

am6xuw00007501

6. Open the lower column cover in the direction of arrow (1) shown in the figure, move the lower column cover in the direction of arrow (2), and detach the tabs of the light switch and the wiper and washer switch from the lower column cover.

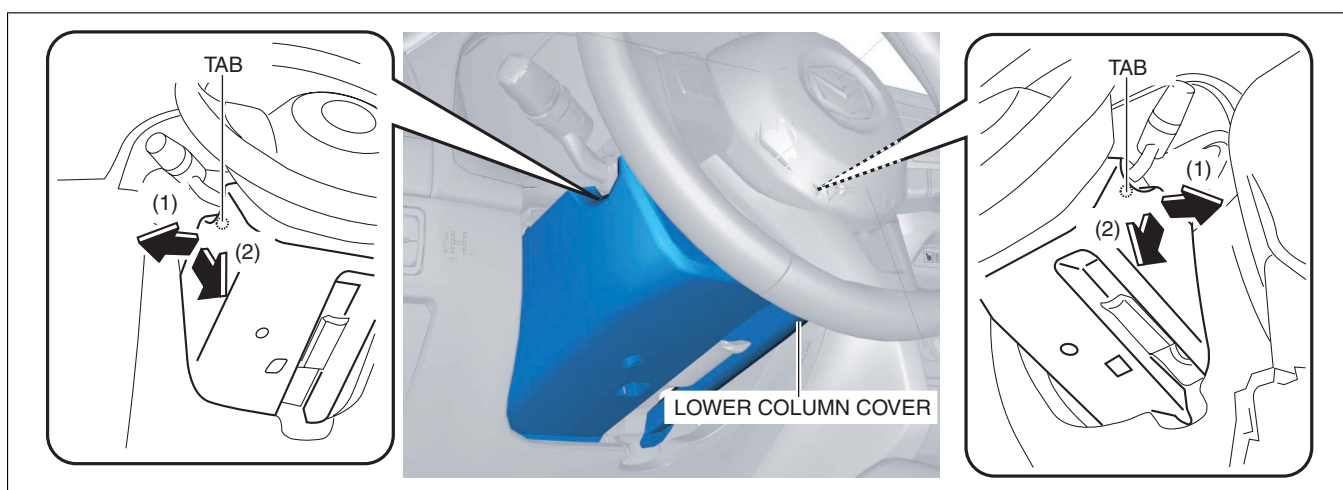

am6xuw00007502

7. Lower the adjusting lever to the bottommost position.

Caution

- If the adjuster lever is pulled down to the bottommost position and the lower column cover is removed while the steering wheel is not secured, the lower column cover will interfere with the driver-side lower panel and could cause damage to the lower column cover and driver-side lower panel. Secure the steering wheel when removing the lower column cover.

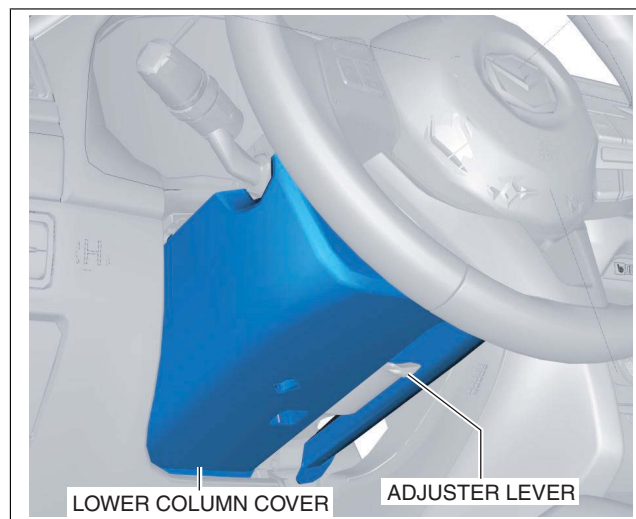

am6xuw00007503

8. Move the lower column cover in the direction of the arrow shown in the figure and remove it while pulling out the guide.

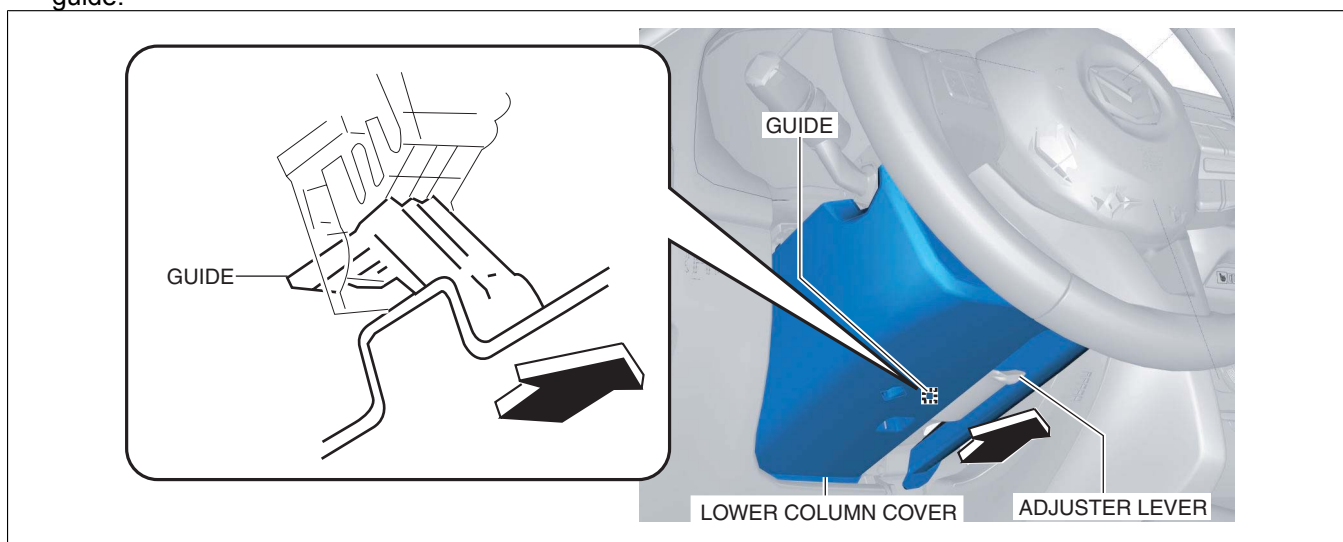

am6xuw00007504

9. Install in the reverse order of removal.